

Cable ladders

Manufacturing from A to Z

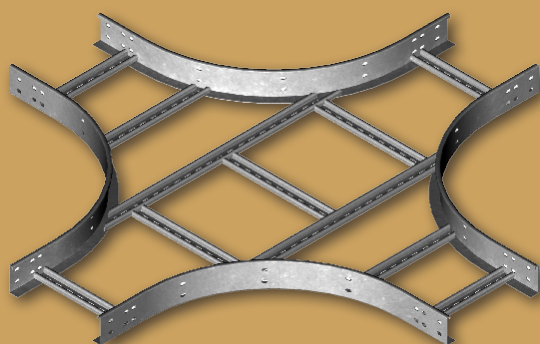

Cable ladders

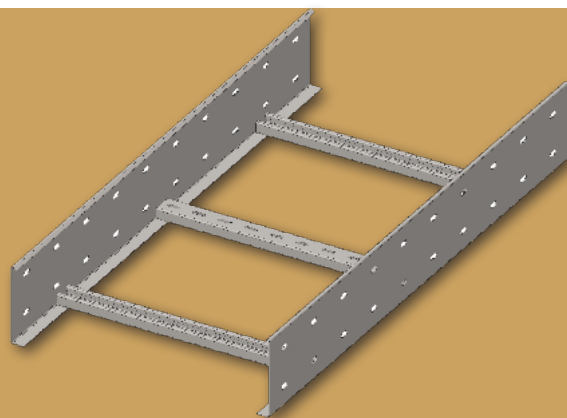
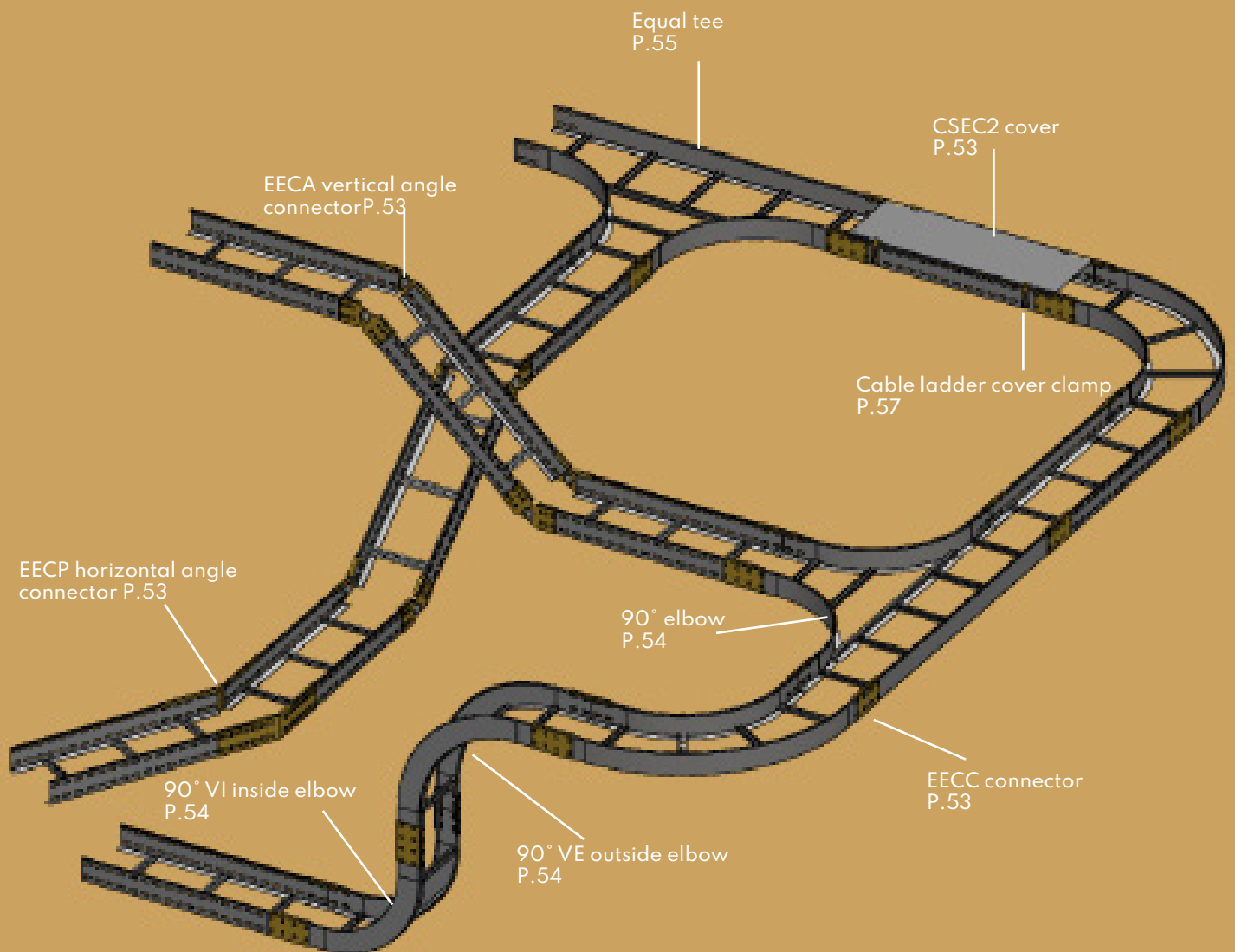

The essentials in **RED** and **BLACK** : Products available on stock
References in **GREEN** : Products on request.

Cable ladders

Cable ladders - Height 100

ECC 4

3 meters. 6 meters on request.
 Three crossbars per metre.
 Other widths and heights on request.
 Stainless steel on request.
 Epoxy optional.
 For assembly with connectors EECC4, EEC4, EECA4, provide four 8x15 TRCC bolts per connector.

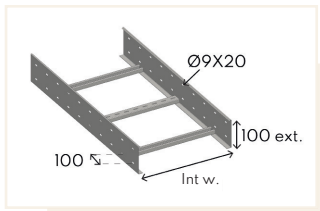

	Pack. ML	Width MM	Kg/ML	HDG
ECC4 200	3	200	4.64	217220
ECC4 300		300	5.24	217230
ECC4 400		400	4.77	217240
ECC4 500		500	4.92	217250
ECC4 600		600	6.32	217260

Load curve ECC4

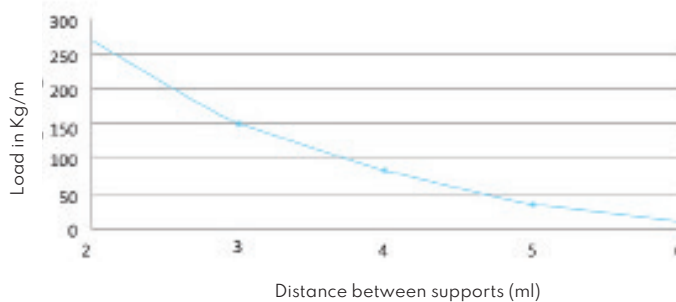

Cable ladders - Height 150

ECC 6

3 meters. 6 meters on request.
 Three crossbars per meter.
 Other widths and heights on request.
 Stainless steel on request.
 Epoxy optional.
 For assembly with connectors EECC6, EEC6, EECA6, provide four 8x15 TRCC bolts per connector.

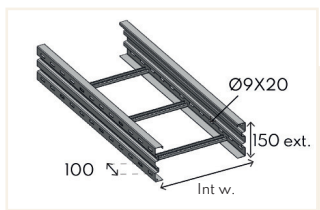

	Pack. ML	Width MM	Kg/ML	HDG
ECC6 200	3	200	7.52	217320
ECC6 300		300	7.83	217330
ECC6 400		400	8.15	217340
ECC6 500		500	8.47	217350
ECC6 600		600	8.79	217360

Load curve ECC6

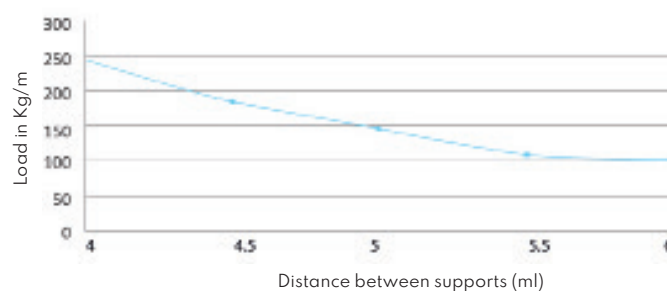

CSEC2

3 meters.

Provide 4 clamps per cover.

	Pack. ML	Width MM	Kg/ML	HDG
CSEC2 200	3	200	1.97	266200
CSEC2 300		300	2.17	266300
CSEC2 400		400	3.47	266400
CSEC2 500		500	5.00	266500
CSEC2 600		600	5.04	266600

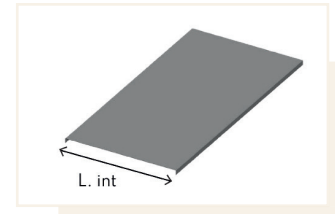

Connecting accessories <

EECC connectors

Fitting between two cable ladders.
Provide four 8x15 TRCC bolts per assembling.

EECC4 HT 100

EECC6 HT 150

	Pack. P	Width MM	Kg/P	HDG
EECC4 connector HT100	10	105	0.51	217200
EECC6 connector HT150		155	1.15	217300

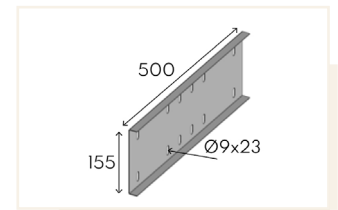
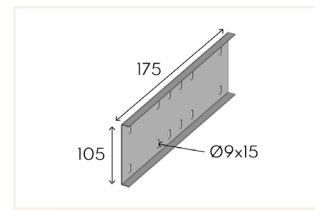

EECP horizontal angle connectors

Change of direction between two cable ladders.
Provide four 8x15 TRCC bolts per assembling.

EECP4 HT 100

EECP6 HT 150

	Pack. P	Width MM	Kg/P	HDG
EECP4 connector HT100	10	105	1.15	217215
EECP4 connector HT150		155	3.19	217315

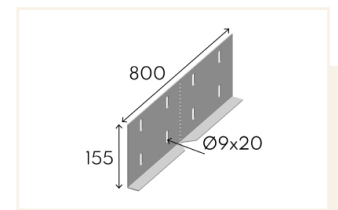
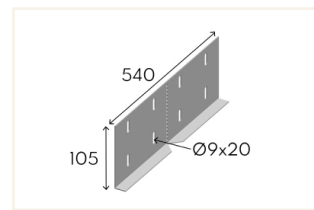

EECA vertical angle connectors

Change of plan between two cable ladders.
Provide four 8x15 TRCC bolts per assembling.

EECA4 HT 100

EECA6 HT 150

	Pack. P	Width MM	Kg/P	HDG
EECA4 connector HT100	10	105	0.40	217210
EECA4 connector HT150		155	2.36	217310

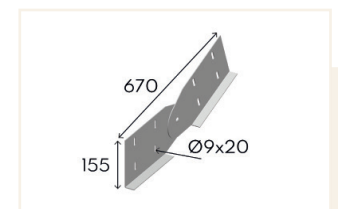
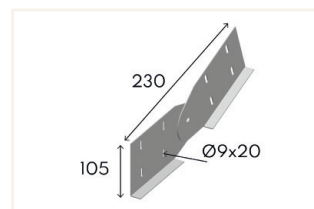

Fitting elements

90° elbow

Other radii on request.
Provide four 8x15 TRCC bolts per connector.

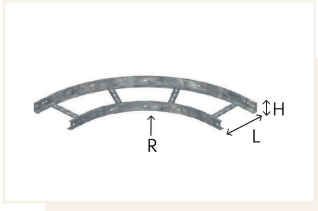

	Pack. P	Height MM	Width MM	Radius MM	Kg/P	HDG
90 elbow - ECC4 200	1	100	200	420	4.42	216220
90 elbow - ECC4 300			300		5.05	216230
90 elbow - ECC4 400			400		5.69	216240
90 elbow - ECC4 500			500		6.32	216250
90 elbow - ECC4 600			600		7.32	216260
90 elbow - ECC6 200	1	150	200	500	6.30	216320
90 elbow - ECC6 300			300		7.20	216330
90 elbow - ECC6 400			400		8.30	216340
90 elbow - ECC6 500			500		9.25	216350
90 elbow - ECC6 600			600		10.15	216360

90° VI inside elbows

Allows a change of plan.
Other radii on request.
Provide four 8x15 TRCC bolts per connector.

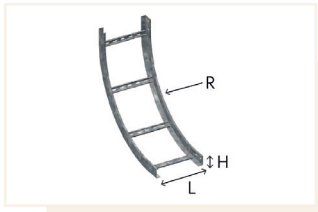

	Pack. P	Height MM	Width MM	Radius MM	Kg/P	HDG
VI - ECC4 200	1	100	200	420	4.73	216220-I
VI - ECC4 300			300		5.40	216230-I
VI - ECC4 400			400		6.09	216240-I
VI - ECC4 500			500		6.76	216250-I
VI - ECC4 600			600		7.83	216260-I
VI - ECC6 200	1	150	200	500	5.80	216320-I
VI - ECC6 300			300		6.45	216330-I
VI - ECC6 400			400		7.05	216340-I
VI - ECC6 500			500		7.60	216350-I
VI - ECC6 600			600		8.10	216360-I

90° VE outside elbows

Allows a change of plan.
Other radii on request.
Provide four 8x15 TRCC bolts per connector.

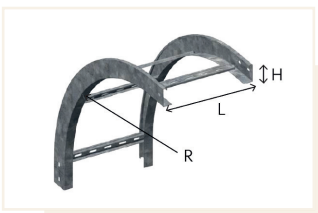

	Pack. P	Height MM	Width MM	Radius MM	Kg/P	HDG
VE - ECC4 200	1	100	200	420	4.73	216220-E
VE - ECC4 300			300		5.40	216230-E
VE - ECC4 400			400		6.09	216240-E
VE - ECC4 500			500		6.76	216250-E
VE - ECC4 600			600		7.83	216260-E
VE - ECC6 200	1	150	200	500	5.80	216320-E
VE - ECC6 300			300		6.45	216330-E
VE - ECC6 400			400		7.05	216340-E
VE - ECC6 500			500		7.60	216350-E
VE - ECC6 600			600		8.10	216360-E

Equal tee

Allows a change of direction.
Other radii on request.
Provide four 8x15 TRCC bolts per connector.

	Pack. P	Height MM	Width MM	Radius MM	Kg/P	HDG
T - ECC4 200	1	100	200	420	7.33	219220
T - ECC4 300			300		8.16	219230
T - ECC4 400			400		9.00	219240
T - ECC4 500			500		9.83	219250
T - ECC4 600			600		12.35	219260
T - ECC6 200	1	150	200	500	10.90	219320
T - ECC6 300			300		12.10	219330
T - ECC6 400			400		13.25	219340
T - ECC6 500			500		14.35	219350
T - ECC6 600			600		15.50	219360

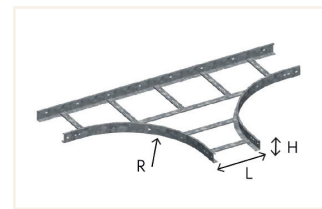

Elbow covers

90° elbow covers

	Pack. P	Radius MM	Kg/P	HDG
CSC 200 - ECC4	1	420	2.90	271720-420
CSC 300 - ECC4			4.51	271730-420
CSC 400 - ECC4			6.29	271740-420
CSC 500 - ECC4			8.26	271750-420
CSC 600 - ECC4			10.42	271760-420
CSC 200 - ECC6	1	500	3.23	271720-500
CSC 300 - ECC6			4.98	271730-500
CSC 400 - ECC6			6.91	271740-500
CSC 500 - ECC6			9.03	271750-500
CSC 600 - ECC6			11.33	271760-500

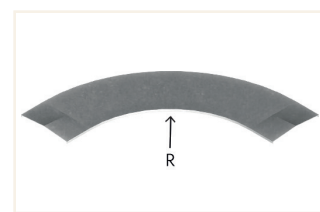

90° VI inside elbow covers

	Pack. P	Kg/P	HDG
CSC I 200 - VI -ECC4	1	1.69	271720-I-420
CSC I 300 - VI -ECC4		2.95	271730-I-420
CSC I 400 - VI -ECC4		3.90	271740-I-420
CSC I 500 - VI -ECC4		4.77	271750-I-420
CSC I 600 - VI -ECC4		5.70	271760-I-420
CSC I 200 - VI -ECC6	1	2.56	271720-I-500
CSC I 300 - VI -ECC6		2.95	271730-I-500
CSC I 400 - VI -ECC6		3.90	271740-I-500
CSC I 500 - VI -ECC6		5.50	271750-I-500
CSC I 600 - VI -ECC6		5.70	271760-I-500

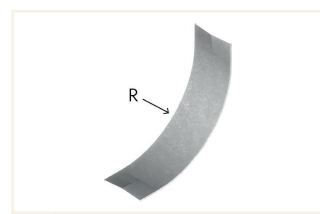

› Fitting elements

90° VE outside elbow covers

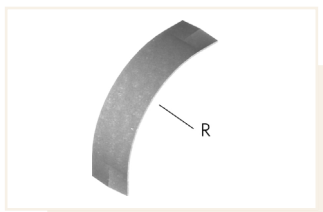

	Pack. P	Kg/P	HDG
CSC E 200 - VE-ECC4	1	2.56	271720-E-420
CSC E 300 - VE-ECC4		3.00	271730-E-420
CSC E 400 - VE-ECC4		3.99	271740-E-420
CSC E 500 - VE-ECC4		5.50	271750-E-420
CSC E 600 - VE-ECC4		5.70	271760-E-420
CSC E 200 - VE-ECC6	1	2.56	271720-E-500
CSC E 300 - VE-ECC6		3.00	271730-E-500
CSC E 400 - VE-ECC6		3.99	271740-E-500
CSC E 500 - VE-ECC6		5.50	271750-E-500
CSC E 600 - VE-ECC6		5.70	271760-E-500

Equal tee covers

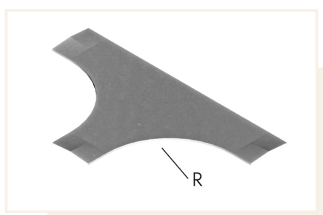

	Pack. P	Radius MM	Kg/P	HDG
CTSE 200 - T-ECC4	1	420	6.63	273720-420
CTSE 300 - T-ECC4			9.81	273730-420
CTSE 400 - T-ECC4			13.31	273740-420
CTSE 500 - T-ECC4			17.12	273750-420
CTSE 600 - T-ECC4			21.25	273760-420
CTSE 200 - T-ECC6	1	500	6.63	273720-500
CTSE 300 - T-ECC6			9.59	273730-500
CTSE 400 - T-ECC6			13.31	273740-500
CTSE 500 - T-ECC6			17.12	273750-500
CTSE 600 - T-ECC6			21.25	273760-500

Cable ladder cover clamp

Allows the cover to be locked onto the cable ladder

	Pack. P	Kg/P	HDG
Cover clamp	25	0.04	265000

Slide the clamp down.

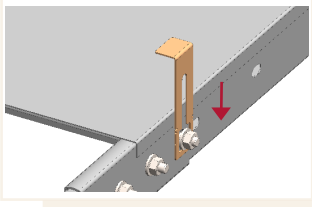

Fold down the bottom of the clamp to secure the assembling.

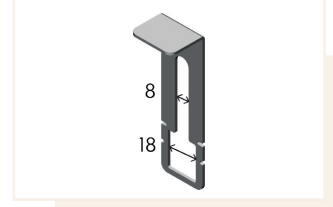
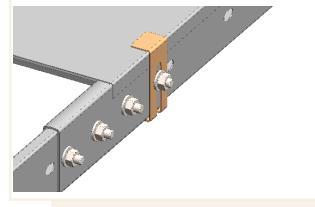
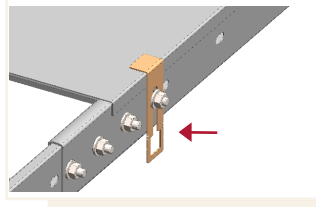

Hold down clamp

Allows ladders to be held on the support. Provide one 8x20 HM screw, one M8 flat washer and one M8 channel nut per clamp.

	Pack. P	Kg/P	HDG
Hold down clamp	25	0.04	264505

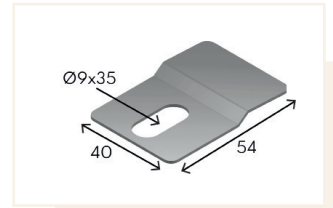
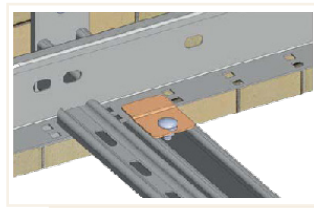

Fasteners <

Fasteners

	Pack. P	Kg/%	Geomet
8x15 TRCC bolt	100	2.12	260815
8x20 HM screw		1.23	230820
Flat washer - 8		0.37	230208
Base nut - 8		0.67	230108
Channel nut - 8		2.60	230408

8x15 TRCC bolt



8x20 HM screw

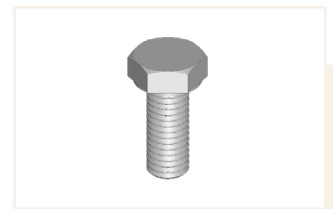

Flat washer - 8

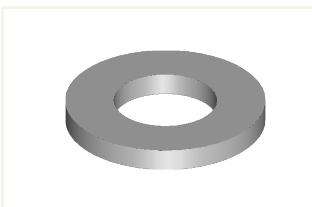

Base nut - 8



Channel nut - 8

